

PATROL 19 WP

FAST SHALLOW DRAFT PATROL VESSEL



More information: sales@bwb.ee

www.bwb.ee

GENERAL

Hull material	Aluminium
Superstructure	Aluminium
Main functions	Patrol, border guard, maritime safety, SAR
Classification	Lloyd's Register

MAIN PARAMETERS

Length overall (m)	18,6
Beam overall (m)	5,1
Draught max (m)	1,1
Crew	2-4

TANK CAPACITIES

Fuel (L)	3000
Fresh water (L)	300
Waste water (L)	300

PERFORMANCES

Speed (kn)	38
Range @ 25 knots (nm)	ca 300
Fuel consumption l/h @ 25 kn	250
Noise level in wheelhouse @ 25 kn (dB)	60

PROPULSION SYSTEM

Main engines	2 x Volvo Penta D13 1000
Total Power (kW)	2 x 735
Gearboxes	2 x ZF500
Propulsion	2 x Kamewa S36-3 waterjet

DECK LAYOUT

Anchor equipment	1 x SHHP anchor
Anchor winch	Italwinch
Boats	Rescue runner jetski
Boat launching	Detachable aft slipway
Towing capability	Emergency towing of similar size vessels

ACCOMMODATION

Main deck	Wheelhouse for crew members and three passengers
Below main deck	Galley, mess, wc/shower, sleeping berths for 4 people

SPECIAL FEATURES

- Rescue davit with rescue net on starboard side of wheelhouse
- Lowered aft deck for SAR operations

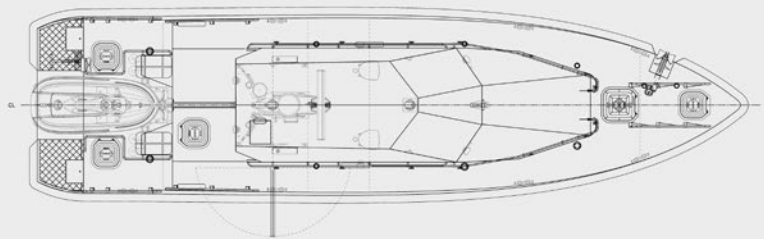
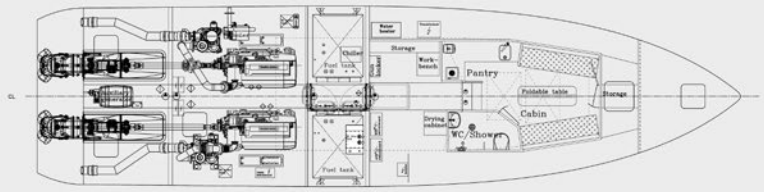
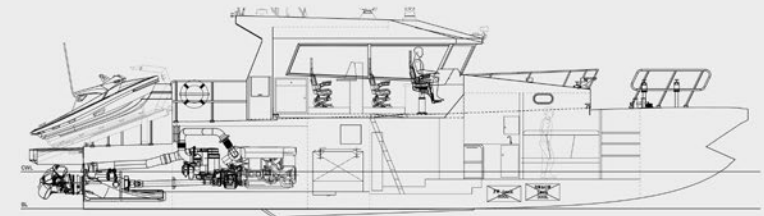

USERS: Estonian Police and Border Guard

Baltic Workboats AS

Nasva Harbour
Sadama 26, Nasva
93872 Saaremaa, Estonia

Phone: +372 45 21140
sales@bwb.ee
balticworkboats.ee

