

# PATROL 45 WP HYBRID

45M MULTIFUNCTIONAL WAVE PIERCING PATROL VESSEL



More information: [sales@bwb.ee](mailto:sales@bwb.ee)

[www.bwb.ee](http://www.bwb.ee)

GENERAL

Hull material	Aluminium
Superstructure	Aluminium
Main functions	Offshore patrol, SAR, combat pollution, FiFi, hydrographic tasks and buoy servicing
Classification	Lloyd's Register 100A1 SSC Patrol Mono HSC G3
Ice class	Hull strengthened for operation in 10 cm solid ice

MAIN DIMENSIONS

Length overall (m)	44,6
Beam overall (m)	8,8
Draught max (m)	2,6
Crew	up to 28

TANK CAPACITIES

Fuel (m³)	30
Fresh water (m³)	2
Waste water (black) (m³)	4
Waste water (grey) (m³)	3,6

PERFORMANCES

Speed (kn)	27
Range @ 10 kn (nm)	3000
Range @ 5 knots fully electrical (nm)	25
Fuel consumption l/h @ 25/10 kn	920 @ 25 kn/ 100 @10 kn
Noise level in accomodation @ 25 kn	60

PROPULSION SYSTEM

Main engines	2x MTU 16V4000
Total Power	2x 2000 kW
Gearboxes	2x ZF9300
Propulsion	2x fixed pitch propellers
Bow thruster	Sleipner SH1400
Aft thruster	Sleipner SH550
Generators	2x Volvo Penta D11 with 375 kW generator for hybrid operations
Batteries	273 kWh

DECK LAYOUT

Deck cranes	HS Marine AK 55 E4
Boats	Aluminium daughter boat + rescue runner
Boat launching	Hull integrated daughter boat compartment
Payload	2 containers and pallets
Towing capability	Similar size vessel

ACCOMMODATION

Below main deck	Cabins for 16 of crew, sauna and gym area
Main deck	Two single cabins, medical room, mess/ galley

SPECIAL FEATURES

Active roll-stabilizing fins, anti-rolling tank, OSD radar, DP system, oilrec capability, 2 x external FiFi monitors

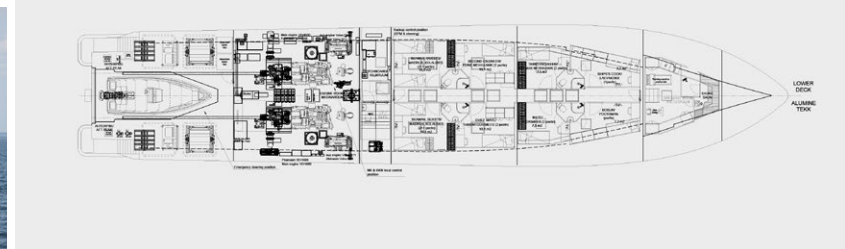
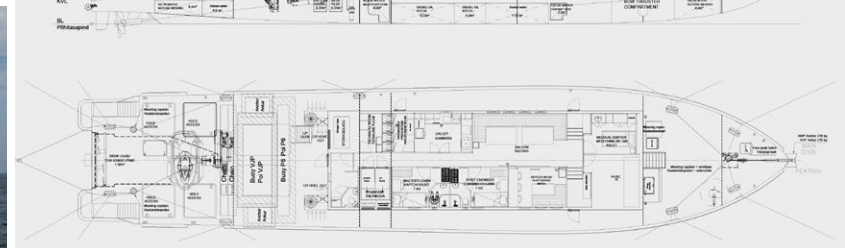
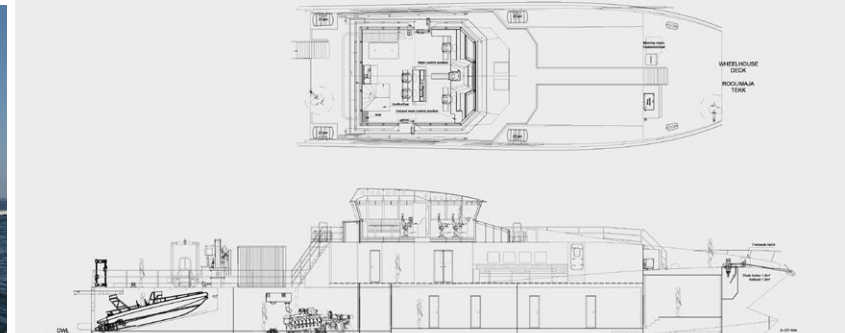
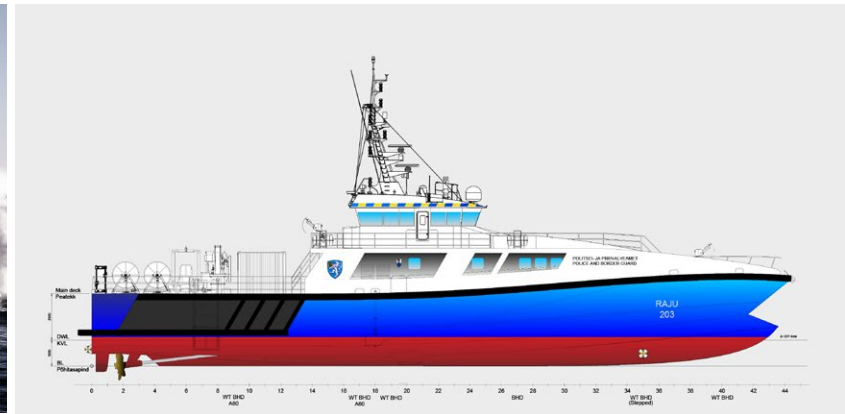

USERS: Estonian Police and Border Guard

Baltic Workboats AS

Nasva Harbour  
Sadama 26, Nasva  
93872 Saaremaa, Estonia

Phone: +372 45 21140  
sales@bwb.ee  
balticworkboats.ee

